

Legend	
	Work Area
	Cone Reflective



WCC 003

Local Road
Dual Lanes

Short Term Works
Less Than 1 Day

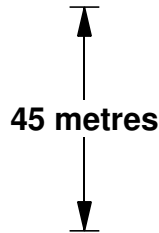

NOTES:

This Traffic Management Plan can be used when speed of passing traffic is less than 60 km/h and distance to the passing traffic is more than 1.2 metres

Sight distance for approaching traffic to be a minimum of 150 metres or more

Minimum 3.0 metres lane width for passing traffic to be provided

Work Vehicle is used as a buffer between the work area and the passing traffic where possible

This treatment shall only be used where traffic can self manage without the requirement for Traffic Controllers

Flashing lights to be illuminated for the duration of the works

Pedestrian and Bicycle access should be maintained

Work Vehicle not required to be in place where parked cars form a safety buffer

Cone spacings to be no greater than 4 metres apart

Operators to move around obstructions where gaps in oncoming traffic allows





Date: 09/11/2017 Author: Damien Petrie Project: Routine Maintenance
Client: City of Whittlesea Site Location: Generic TMP

Comments:
Copyright 2017 DeDeploy Management Solutions Pty. Ltd.

Copying of diagram is not permitted without written permission from Damien Petrie, DeDeploy Management Solutions Pty. Ltd. 03 9879 7422

Legend

-  Work Area
-  Cone Reflective

WCC 007

Local Road
Two Lanes
T - Interstecion

Short Term Works
Less Than 1 Day



← 15 metres →

NOTES:

This Traffic Management Plan can be used when speed of passing traffic is less than 60 km/h and distance to the passing traffic is more than 1.2 metres

Sight distance for approaching traffic to be a minimum of 150 metres or more

Work Vehicle is used as a buffer between the work area and the passing traffic where possible

Flashing lights to be illuminated for the duration of the works

Pedestrian and Bicycle access should be maintained

Work Vehicle not required to be in place where parked cars form a safety buffer

Cone spacings to be no greater than 4 metres apart

Operators to move around obstructions where gaps in oncoming traffic allows

60 metre
merge taper

45 metres

45 metres

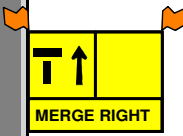
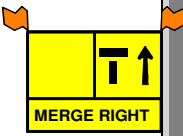
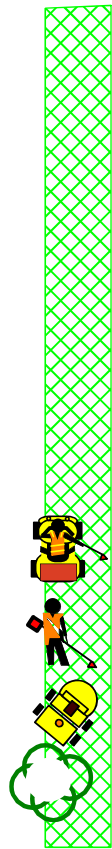

Date: 09/11/2017 Author: Damien Petrie Project: Routine Maintenance
Client: City of Whittlesea Site Location: Generic TMP

Comments:
Copyright 2017 DeDeploy Management Solutions Pty. Ltd.

Copying of diagram is not permitted without written permission from Damien Petrie, DeDeploy Management Solutions Pty. Ltd. 03 9879 7422

Legend

 Cone Reflective

 Work Area



**City of
Whittlesea**

WCC 029

Local Road
Two Lanes

Short Term Works
Less Than 1 Day

 Or Less

45 metres

90 metres

NOTES:

This Traffic Management Plan can be used when speed of passing traffic is less than 60 km/h and distance to the passing traffic is more than 1.2 metres

Sight distance for approaching traffic to be a minimum of 150 metres or more

Work Vehicle is used as a buffer between the work area and the passing traffic where possible

This treatment shall only be used where traffic cannot "Give & Take" self manage without the requirement for Traffic Controllers.

Flashing lights to be illuminated for the duration of the works

Pedestrian and Bicycle access should be maintained

Cones spacings to be no greater than 4 metres apart

15 metre
taper

90 metres

45 metres





Date: 09/11/2017 **Author:** Damien Petrie **Project:** Routine Maintenance
Client: City of Whittlesea **Site Location:** Generic TMP

Comments:

Copyright 2017 DeDeploy Management Solutions Pty. Ltd.

Copying of diagram is not permitted without written permission from Damien Petrie, DeDeploy Management Solutions Pty. Ltd. 03 9879 7422

Legend

-  Cone Reflective
-  Work Area



WCC 030

Local Road
Dual Lanes

Short Term Works
Less Than 1 Day



45 metres

NOTES:

This Traffic Management Plan can be used when speed of passing traffic is less than 60 km/h and distance to the passing traffic is more than 1.2 metres

Sight distance for approaching traffic to be a minimum of 150 metres or more

Minimum 3.0 lane width for passing traffic to be provided

Work Vehicle is used as a buffer between the work area and the passing traffic where possible

Flashing lights to be illuminated for the duration of the works

Pedestrian and Bicycle access should be maintained

Cone spacings to be no greater than 4 metres apart

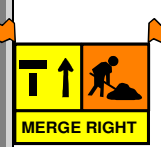
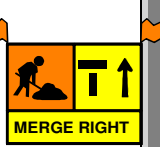
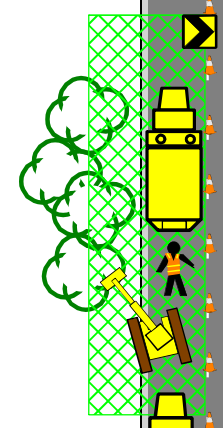

60 metre taper

45 metres



	<p>Date: 09/11/2017 Author: Damien Petrie Project: Routine Maintenance Client: City of Whittlesea Site Location: Generic TMP</p>
	<p>Comments: Copyright 2017 DeDeploy Management Solutions Pty. Ltd. Copying of diagram is not permitted without written permission from Damien Petrie, DeDeploy Management Solutions Pty. Ltd. 03 9879 7422</p>

Legend

-  Cone Reflective
-  Work Area

45 metres

90 metres

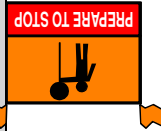
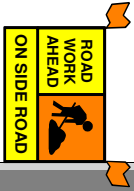

City of Whittlesea

WCC 032

Local Road
Two Lanes
Intersection

Short Term Works
Less Than 1 Day



45 metres

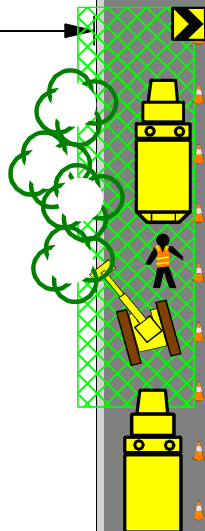

45 metres

NOTES:

This Traffic Management Plan can be used when speed of passing traffic is less than 60 km/h and distance to the passing traffic is more than 1.2 metres

Sight distance for approaching traffic to be a minimum of 150 metres or more

Work Vehicle is used as a buffer between the work area and the passing traffic where possible

This treatment shall only be used where traffic cannot "Give & Take" self manage without the requirement for Traffic Controllers.

Flashing lights to be illuminated for the duration of the works

Pedestrian and Bicycle access should be maintained

Cones spacings to be no greater than 4 metres apart

15 metre taper

90 metres

45 metres





Date: 09/11/2017 Author: Damien Petrie Project: Routine Maintenance Client: City of Whittlesea Site Location: Generic TMP

Comments: Copyright 2017 DeDeploy Management Solutions Pty. Ltd.

Copying of diagram is not permitted without written permission from Damien Petrie, DeDeploy Management Solutions Pty. Ltd. 03 9879 7422

Legend

-  Cone Reflective
-  Work Area

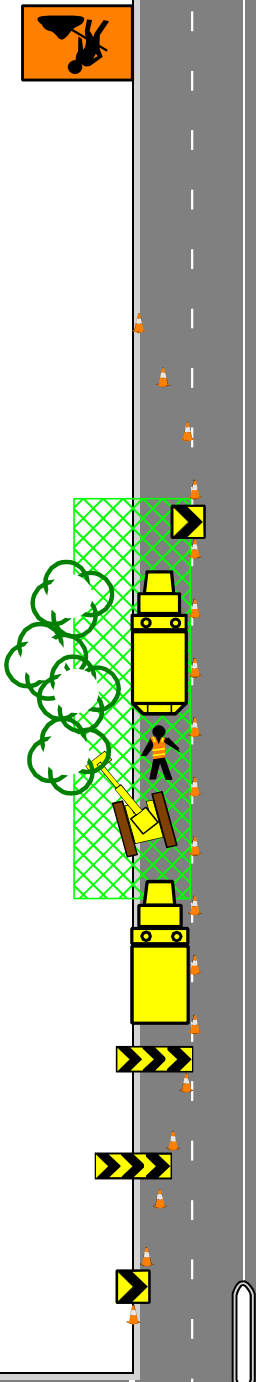

60 metre taper

ROAD WORK AHEAD
ON SIDE ROAD



City of Whittlesea

WCC 033

Local Road
Dual Lanes
Intersection

Short Term Works
Less Than 1 Day



45 metres

15 metres

NOTES:

This Traffic Management Plan can be used when speed of passing traffic is less than 60 km/h and distance to the passing traffic is more than 1.2 metres

Sight distance for approaching traffic to be a minimum of 150 metres or more

Work Vehicle is used as a buffer between the work area and the passing traffic where possible

Flashing lights to be illuminated for the duration of the works

Pedestrian and Bicycle access should be maintained

Cone spacings to be no greater than 4 metres apart

ROAD WORK AHEAD
ON SIDE ROAD

45 metres

15 metres

MERGE RIGHT

MERGE RIGHT





Date: 09/11/2017 Author: Damien Petrie Project: Routine Maintenance
Client: City of Whittlesea Site Location: Generic TMP

Comments:
Copyright 2017 DeDeploy Management Solutions Pty. Ltd.

Copying of diagram is not permitted without written permission from Damien Petrie, DeDeploy Management Solutions Pty. Ltd. 03 9879 7422

Legend

-  Cone Reflective
-  Work Area

45 metres

90 metres



WCC 034

Local Road
Two Lanes
Intersection

Short Term Works
Less Than 1 Day

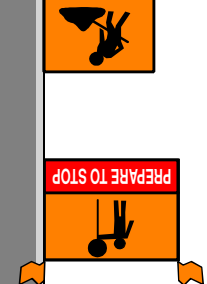
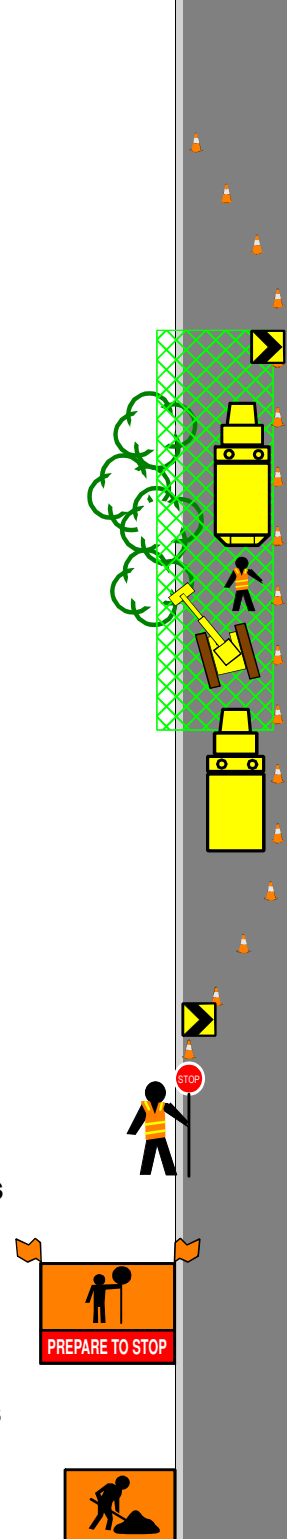

45 metres

NOTES:

This Traffic Management Plan can be used when speed of passing traffic is less than 60 km/h and distance to the passing traffic is more than 1.2 metres

Sight distance for approaching traffic to be a minimum of 150 metres or more

Work Vehicle is used as a buffer between the work area and the passing traffic where possible

This treatment shall only be used where traffic cannot "Give & Take" self manage without the requirement for Traffic Controllers.

Flashing lights to be illuminated for the duration of the works

Pedestrian and Bicycle access should be maintained

Cones spacings to be no greater than 4 metres apart





Date: 09/11/2017 Author: Damien Petrie Project: Routine Maintenance
Client: City of Whittlesea Site Location: Generic TMP

Comments:
Copyright 2017 DeDeploy Management Solutions Pty. Ltd.

Copying of diagram is not permitted without written permission from Damien Petrie, DeDeploy Management Solutions Pty. Ltd. 03 9879 7422

Legend

-  Cone Reflective
-  Work Area



City of Whittlesea

WCC 035

Local Road
Dual Lanes
Interstecion

Short Term Works
Less Than 1 Day



45 metres

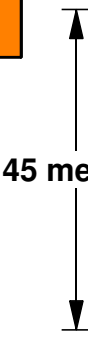

NOTES:

This Traffic Management Plan can be used when speed of passing traffic is less than 60 km/h and distance to the passing traffic is more than 1.2 metres

Sight distance for approaching traffic to be a minimum of 150 metres or more

Work Vehicle is used as a buffer between the work area and the passing traffic where possible

Flashing lights to be illuminated for the duration of the works

Pedestrian and Bicycle access should be maintained

Cone spacings to be no greater than 4 metres apart

15 metres



60 metre taper

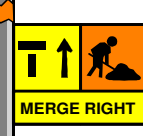
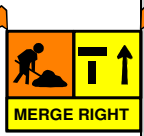
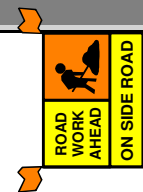
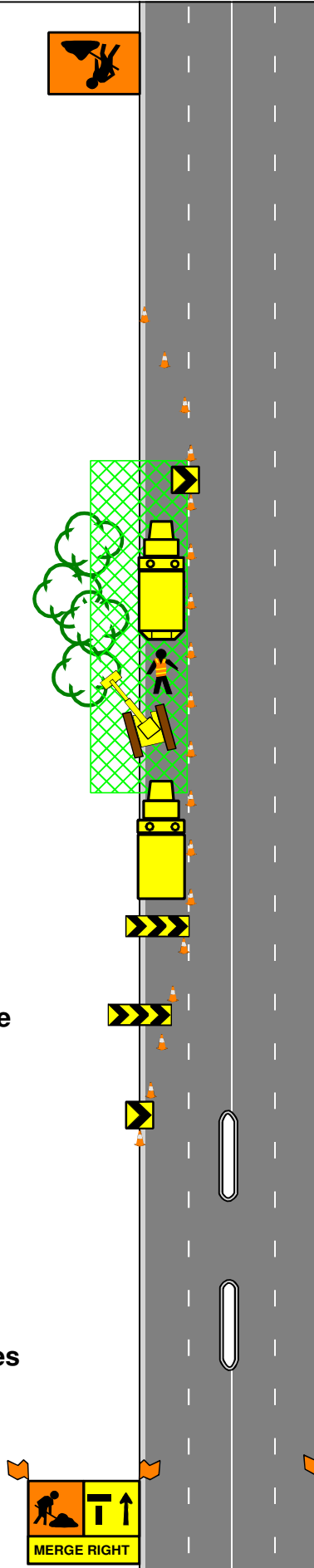

45 metres



Date: 09/11/2017 **Author:** Damien Petrie **Project:** Routine Maintenance
Client: City of Whittlesea **Site Location:** Generic TMP

Comments:
 Copyright 2017 DeDeploy Management Solutions Pty. Ltd.
 Copying of diagram is not permitted without written permission from Damien Petrie, DeDeploy Management Solutions Pty. Ltd. 03 9879 7422

Legend

-  Cone Reflective
-  Work Area



City of Whittlesea

WCC 040

Local Road
Two Lanes

Short Term Works
Less Than 1 Day



30 metre taper

90 metres

45 metres

NOTES:

This Traffic Management Plan can be used when speed of passing traffic is less than 60 km/h and distance to the passing traffic is more than 1.2 metres

This treatment shall only be used where traffic cannot "Give & Take" self manage without the requirement for Traffic Controllers

Sight distance for approaching traffic to be a minimum of 150 metres or more

Work Vehicle is used as a buffer between the work area and the passing traffic where possible

Flashing lights to be illuminated for the duration of the works

Pedestrian and Bicycle access should be maintained

Work Vehicle not required to be in place where parked cars form a safety buffer

Cone spacings to be no greater than 4 metres apart

When the required sight distance cannot be achieved an alternative plan and or Traffic Controllers must be employed for worker safety







Date: 09/11/2017 Author: Damien Petrie Project: Routine Maintenance
Client: City of Whittlesea Site Location: Generic TMP

Comments:
Copyright 2017 DeDeploy Management Solutions Pty. Ltd.

Copying of diagram is not permitted without written permission from Damien Petrie, DeDeploy Management Solutions Pty. Ltd. 03 9879 7422

Legend

-  Work Area
-  Tubular
-  Parawebbing
-  Cone Reflective



City of Whittlesea

WCC 046

Local Road
Two Lanes

Short Term Works
Less Than 1 Day



45 metres

90 metres

NOTES:

This Traffic Management Plan can be used when speed of passing traffic is less than 60 km/h and distance to the passing traffic is more than 1.2 metres

Work Vehicle is used as a buffer between the work area and the passing traffic where possible

This treatment shall only be used where traffic cannot "Give & Take" self manage without the requirement for Traffic Controllers.

Flashing lights to be illuminated for the duration of the works

Pedestrian and Bicycle access should be maintained

Work Vehicle not required to be in place where parked cars form a safety buffer

Cone spacings to be no greater than 4 metres apart



15 metre taper

90 metres

45 metres



Date: 09/11/2017 Author: Damien Petrie Project: Routine Maintenance
Client: City of Whittlesea Site Location: Generic TMP

Comments:
Copyright 2017 DeDeploy Management Solutions Pty. Ltd.





Copying of diagram is not permitted without written permission from Damien Petrie, DeDeploy Management Solutions Pty. Ltd. 03 9879 7422

WCC 047

Local Road
Dual Lanes

Short Term Works
Less Than 1 Day



Legend	
	Work Area
	Tubular
	Parawebbing
	Cone Reflective

45 metres



Minimum 1.2 metres unimpeded access for pedestrians is to be provided at all times

1.2 metres unimpeded safety buffer from passing traffic is to be provided at all times

NOTES:

This Traffic Management Plan can be used when speed of passing traffic is less than 60 km/h and distance to the passing traffic is more than 1.2 metres

Sight distance for approaching traffic to be a minimum of 150 metres or more

Minimum 3.0 lane width for passing traffic to be provided

Work Vehicle is used as a buffer between the work area and the passing traffic where possible

Flashing lights to be illuminated for the duration of the works

Pedestrian and Bicycle access should be maintained

Cone spacings to be no greater than 4 metres apart

Work Vehicle not required to be in place where parked cars form a safety buffer

60 metre taper

45 metres







Date: 09/11/2017 Author: Damien Petrie Project: Routine Maintenance
Client: City of Whittlesea Site Location: Generic TMP

Comments:
Copyright 2017 DeDeploy Management Solutions Pty. Ltd.

Copying of diagram is not permitted without written permission from Damien Petrie, DeDeploy Management Solutions Pty. Ltd. 03 9879 7422

Legend

-  Work Area
-  Tubular
-  Parawebbing
-  Cone Reflective



WCC 048

Local Road
Two Lanes
Intersection

Short Term Works
Less Than 1 Day

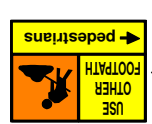
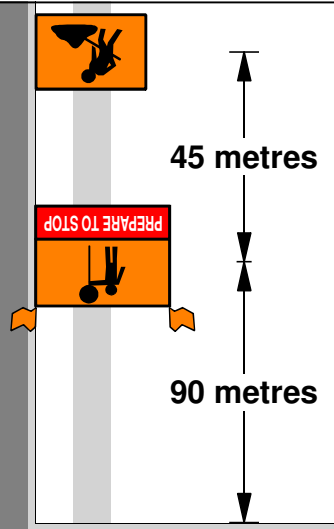
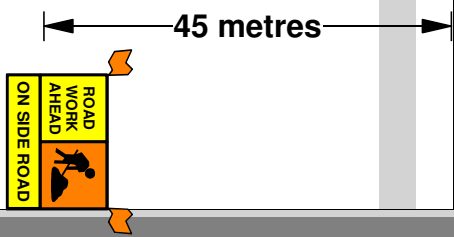

15 metre taper

90 metres

45 metres

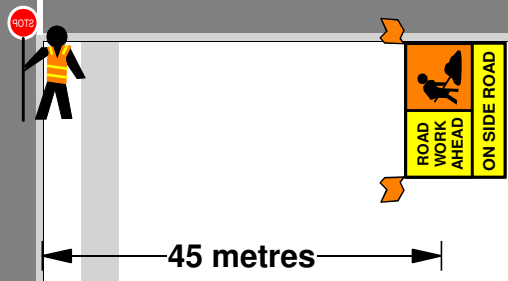

NOTES:

This Traffic Management Plan can be used when speed of passing traffic is less than 60 km/h and distance to the passing traffic is more than 1.2 metres

Work Vehicle is used as a buffer between the work area and the passing traffic where possible

This treatment shall only be used where traffic cannot "Give & Take" self manage without the requirement for Traffic Controllers.

Flashing lights to be illuminated for the duration of the works

Pedestrian and Bicycle access should be maintained

Cones spacings to be no greater than 4 metres apart



Date: 09/11/2017 Author: Damien Petrie Project: Routine Maintenance
Client: City of Whittlesea Site Location: Generic TMP

Comments:
Copyright 2017 DeDeploy Management Solutions Pty. Ltd.

Copying of diagram is not permitted without written permission from Damien Petrie, DeDeploy Management Solutions Pty. Ltd. 03 9879 7422

WCC 049

Local Road
Dual Lanes
Intersection

Short Term Works
Less Than 1 Day



Legend

- Work Area
- Tubular
- Parawebbing
- Cone Reflective

45 metres

Minimum 1.2 metres unimpeded access for pedestrians is to be provided at all times

1.2 metres unimpeded safety buffer from passing traffic is to be provided at all times

NOTES:

This Traffic Management Plan can be used when speed of passing traffic is less than 60 km/h and distance to the passing traffic is more than 1.2 metres

Sight distance for approaching traffic to be a minimum of 150 metres or more

Minimum 3.0 lane width for passing traffic to be provided

Work Vehicle is used as a buffer between the work area and the passing traffic where possible

Flashing lights to be illuminated for the duration of the works

Pedestrian and Bicycle access should be maintained

Cone spacings to be no greater than 4 metres apart

Work Vehicle not required to be in place where parked cars form a safety buffer

60 metre taper

45 metres

45 metres

45 metres







Date: 09/11/2017 Author: Damien Petrie Project: Routine Maintenance
Client: City of Whittlesea Site Location: Generic TMP

Comments:
Copyright 2017 DeDeploy Management Solutions Pty. Ltd.

Copying of diagram is not permitted without written permission from Damien Petrie, DeDeploy Management Solutions Pty. Ltd. 03 9879 7422

Legend

-  Work Area
-  Cone Reflective
-  Tubular
-  Parawebbing



WCC 050

Local Road
Two Lanes
Intersection

Short Term Works
Less Than 1 Day

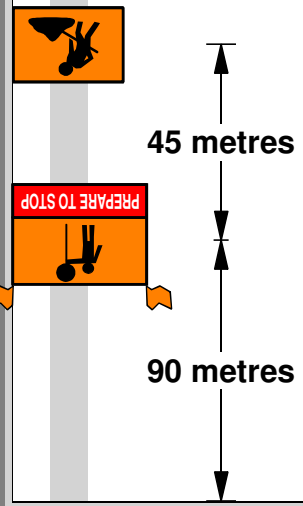

30 metre taper

90 metres

45 metres

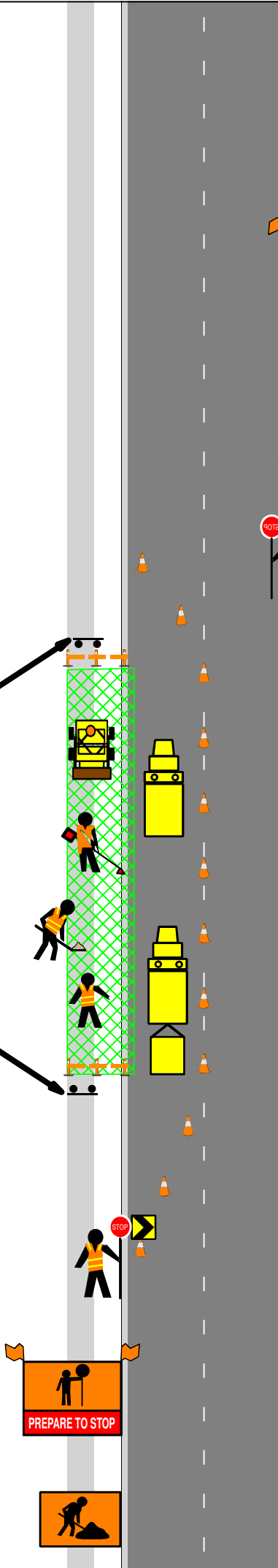

45 metres

NOTES:

This Traffic Management Plan can be used when speed of passing traffic is less than 60 km/h and distance to the passing traffic is more than 1.2 metres

Work Vehicle is used as a buffer between the work area and the passing traffic where possible

This treatment shall only be used where traffic cannot "Give & Take" self manage without the requirement for Traffic Controllers.

Flashing lights to be illuminated for the duration of the works

Pedestrian and Bicycle access should be maintained

Cones spacings to be no greater than 4 metres apart







Date: 09/11/2017 Author: Damien Petrie Project: Routine Maintenance
Client: City of Whittlesea Site Location: Generic TMP

Comments:
Copyright 2017 DeDeploy Management Solutions Pty. Ltd.

Copying of diagram is not permitted without written permission from Damien Petrie, DeDeploy Management Solutions Pty. Ltd. 03 9879 7422

Legend

-  Parawebbing
-  Tubular
-  Work Area
-  Cone Reflective

WCC 051

Local Road
Dual Lanes
Intersection

Short Term Works
Less Than 1 Day



45 metres



Minimum 1.2 metres unimpeded access for pedestrians is to be provided at all times

1.2 metres unimpeded safety buffer from passing traffic is to be provided at all times

NOTES:

This Traffic Management Plan can be used when speed of passing traffic is less than 60 km/h and distance to the passing traffic is more than 1.2 metres

Sight distance for approaching traffic to be a minimum of 150 metres or more

Minimum 3.0 lane width for passing traffic to be provided

Work Vehicle is used as a buffer between the work area and the passing traffic where possible

Flashing lights to be illuminated for the duration of the works

Pedestrian and Bicycle access should be maintained

Cone spacings to be no greater than 4 metres apart

Work Vehicle not required to be in place where parked cars form a safety buffer

60 metre taper



45 metres

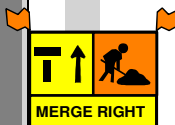
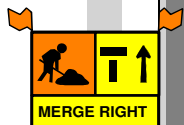

45 metres





Date: 09/11/2017 Author: Damien Petrie Project: Routine Maintenance
Client: City of Whittlesea Site Location: Generic TMP

Comments:
Copyright 2017 DeDeploy Management Solutions Pty. Ltd.

Copying of diagram is not permitted without written permission from
Damien Petrie, DeDeploy Management Solutions Pty. Ltd. 03 9879 7422

Legend

-  Work Area
-  Cone Reflective



WCC 062

Main Road
Dual Lanes

Short Term Work
Less than 1 Day

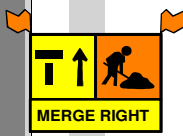
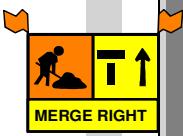
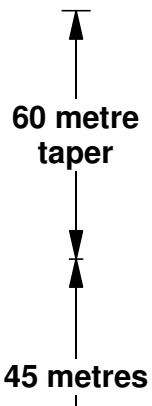
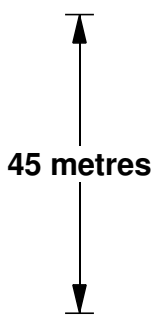

NOTES:

- This Traffic Management Plan can be used when speed of passing traffic is less than 60 km/h and distance to the passing traffic is more than 1.2 metres
- Work Vehicle is used as a buffer between the work area and the passing traffic where possible
- Flashing lights to be illuminated for the duration of the works
- Pedestrian and Bicycle access should be maintained
- Cones spacings to be no greater than 4 metres apart
- Minimum 3.0 lane width for passing traffic to be provided
- Pedestrians to be supervised through worksite at all times





Date: 09/11/2017 Author: Damien Petrie Project: Routine Maintenance
Client: City of Whittlesea Site Location: Generic TMP

Comments:
Copyright 2017 DeDeploy Management Solutions Pty. Ltd.

Copying of diagram is not permitted without written permission from
Damien Petrie, DeDeploy Management Solutions Pty. Ltd. 03 9879 7422

Legend

-  Work Area
-  Cone Reflective

WCC 063

Local Road
Two Lanes

Short Term Work
Less than 1 Day

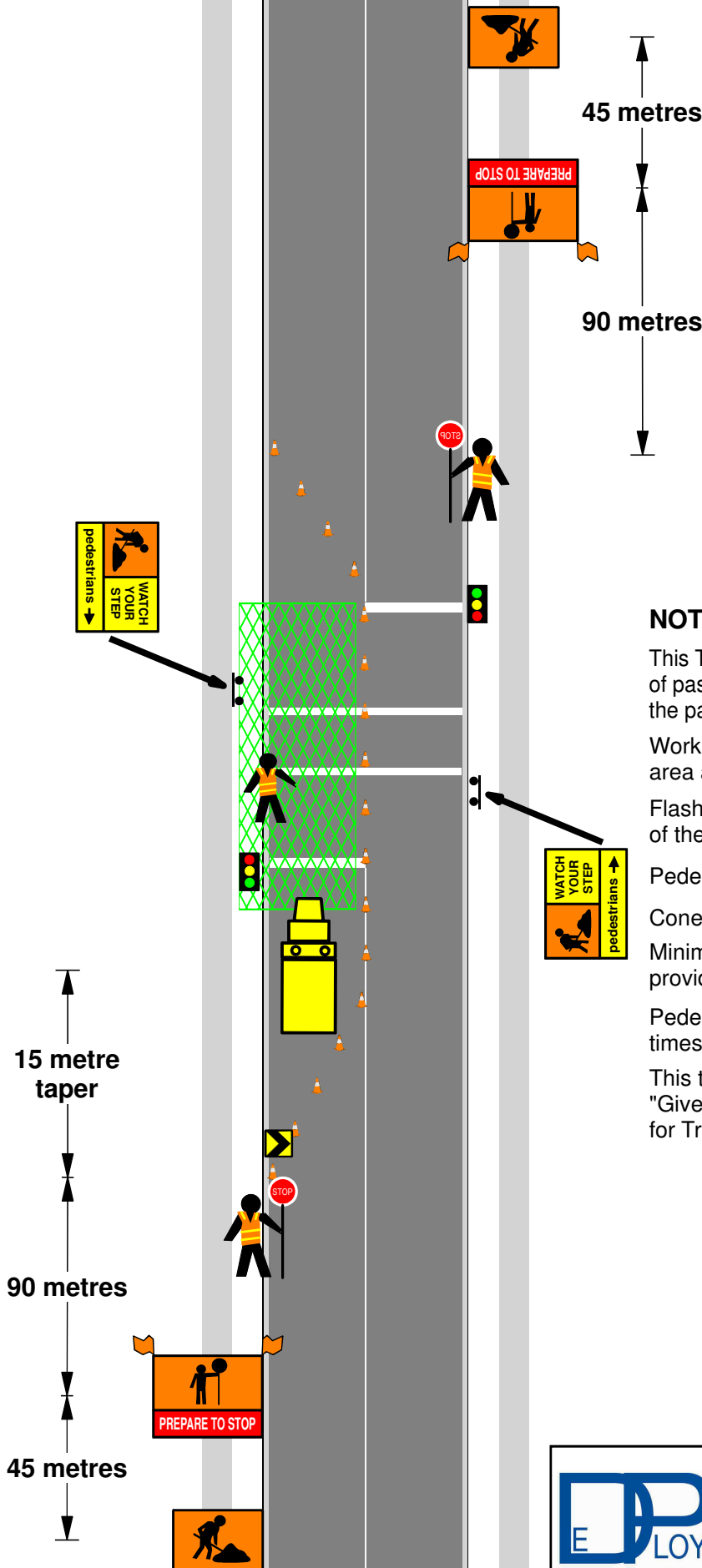

NOTES:

- This Traffic Management Plan can be used when speed of passing traffic is less than 60 km/h and distance to the passing traffic is more than 1.2 metres
- Work Vehicle is used as a buffer between the work area and the passing traffic where possible
- Flashing lights to be illuminated for the duration of the works
- Pedestrian and Bicycle access should be maintained
- Cones spacings to be no greater than 4 metres apart
- Minimum 3.0 lane width for passing traffic to be provided
- Pedestrians to be supervised through worksite at all times
- This treatment shall only be used where traffic cannot "Give & Take" self manage without the requirement for Traffic Controllers.



Date: 09/11/2017 **Author:** Damien Petrie **Project:** Routine Maintenance
Client: City of Whittlesea **Site Location:** Generic TMP

Comments:
Copyright 2017 DeDeploy Management Solutions Pty. Ltd.

Copying of diagram is not permitted without written permission from Damien Petrie, DeDeploy Management Solutions Pty. Ltd. 03 9879 7422

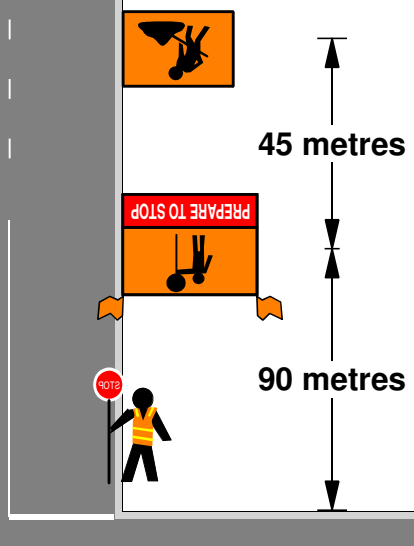
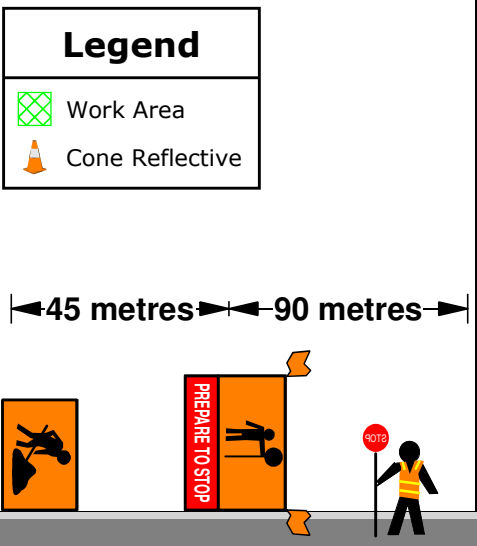

WCC 068

Local Road
Two Lanes
Intersection

Short Term Works
Less Than 1 Day

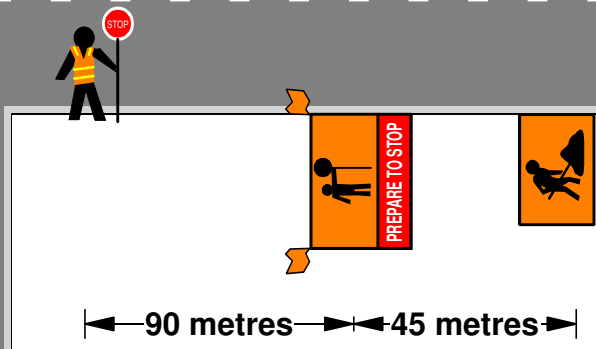
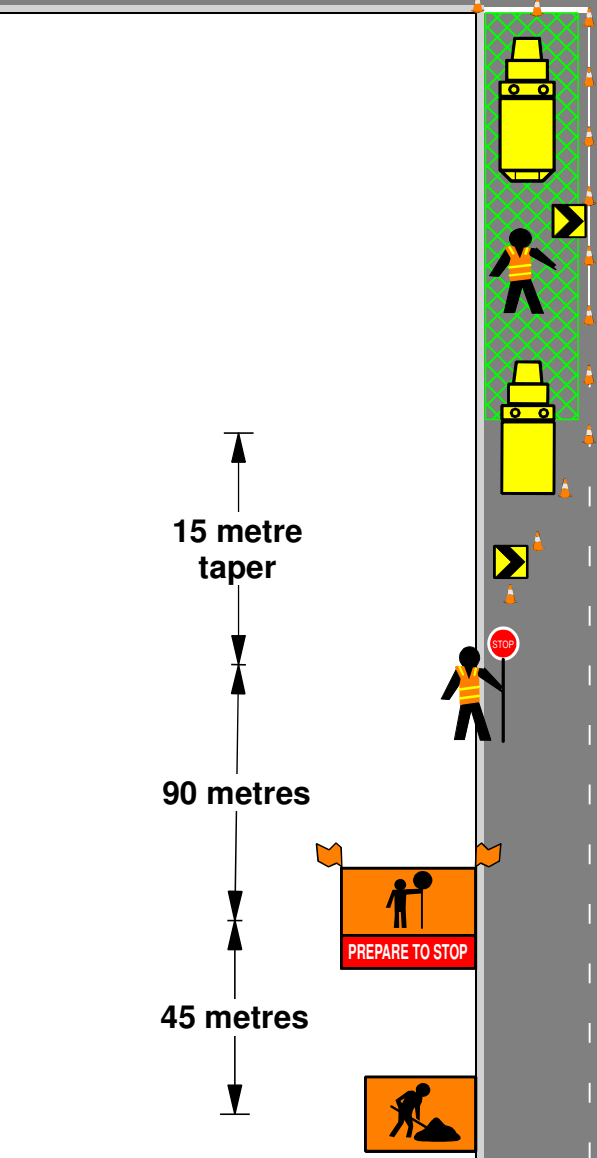

NOTES:

This Traffic Management Plan can be used when speed of passing traffic is less than 60 km/h and distance to the passing traffic is more than 1.2 metres

Sight distance for approaching traffic to be a minimum of 150 metres or more

Work Vehicle is used as a buffer between the work area and the passing traffic where possible

This treatment shall only be used where traffic cannot "Give & Take" self manage without the requirement for Traffic Controllers.

Flashing lights to be illuminated for the duration of the works

Pedestrian and Bicycle access should be maintained

Cones spacings to be no greater than 4 metres apart



Date: 09/11/2017 Author: Damien Petrie Project: Routine Maintenance
Client: City of Whittlesea Site Location: Generic TMP

Comments:
Copyright 2017 DeDeploy Management Solutions Pty. Ltd.

Copying of diagram is not permitted without written permission from Damien Petrie, DeDeploy Management Solutions Pty. Ltd. 03 9879 7422